

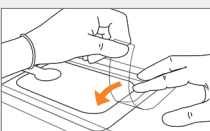

Application guide

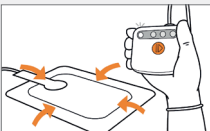

1. Clean and prepare wound according to local protocol.
- Dress**
 2. Peel off the central release handle and place the dressing centrally over the wound. The port should be uppermost from the wound.
 3. Remove the other two handles and smooth the dressing around the wound to prevent creasing.

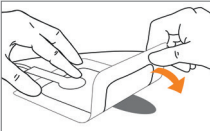

- Press**
 4. Insert the batteries into the device.
 5. Join the device to the dressing by twisting together the tubing connectors.
 6. Press the orange button to start the application of negative pressure. The green light will start to flash (indicates system working OK).
- Go**
 7. Apply the fixation strips to each of the four sides of the dressing.
 8. The device has a 7-day life and the dressing may be left in place for up to 7 days depending on the level of exudate.
 9. When a filler is used, the filler and the PICO dressing should be changed 2 to 3 times a week.

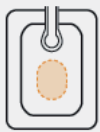

A Dressing properly positioned and is acceptable to be left in place

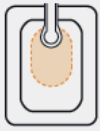

B Dressing requires change - port may block with fluid

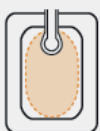

C Dressing requires change - absorbent area is full

Ordering information

Dressing	Dressing size	2 x dressing kit*	1 x dressing kit**	Multipacks***
	10cm x 20cm	66802002	66802012	66802022
	10cm x 30cm	66802003	66802013	66802023
	10cm x 40cm	66802004	66802014	66802024
	15cm x 15cm	66802005	66802015	66802025
	15cm x 20cm	66802006	66802016	66802026
	15cm x 30cm	66802007	66802017	66802027
	20cm x 20cm	66802008	66802018	66802028
	25cm x 25cm	66802009	66802019	66802029
	Mutisite small 15cm x 20cm	66802000	66802010	66802020
	Mutisite large 20cm x 25cm	66802001	66802011	66802021
Consumables		Product code		
	Foam dressing filler	10cm x 12.5cm	66801021	
	Gauze dressing filler	15cm x 17cm	66802127	

*2 x dressing kit = 2 dressings + 1 pump; **1 x dressing kit = 1 dressing + 1 pump; ***Multipacks = 5 dressings only

Smith & Nephew Inc
2280 Argentia Rd
Mississauga
ON L5N 6H8,
Canada
T 1-800-463-7439
F 1-800-671-9140

www.smith-nephew.com/canada

*Trademark of Smith & Nephew All
Trademarks acknowledged
©January 2019 Smith & Nephew
PICO-SA-1901EN (CA05960)

For detailed product information, including indications for use, contraindications, effects, precautions, warnings, and important safety information, please always consult product's Information for Use (IFU) prior to use.

Supporting healthcare professionals for over 150 years

References:
1. Data on File. DS.16.352.R Measurement of NPWT device air leak tolerance – PICO® vs PICO II. September 2016; 2. Data on File. DS.16.351.R Comparison of noise levels generated by the PICO and PICO II devices in operation. September 2016; 3. WMP11446.UEF/R3 Project Fairbanks Human Factors Summary Report Issue 5. G Walker, May 2017; 4. Smith and Nephew 2018. The review of evidence supporting the use of PICO in wounds ≥2cm in depth. Internal report. EO.AWM.PCS230.001.v2

Now indicated for deeper wounds >2cm



PICO[®] 7 system
Quick reference guide
(now including deeper wounds)

smith-nephew.com/pico

 **smith&nephew**
PICO[®] 7
Single Use Negative Pressure
Wound Therapy System

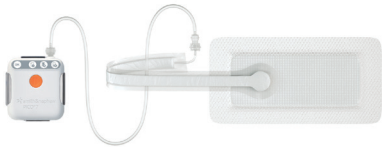

Supporting healthcare professionals

PICO° 7

pioneering technology

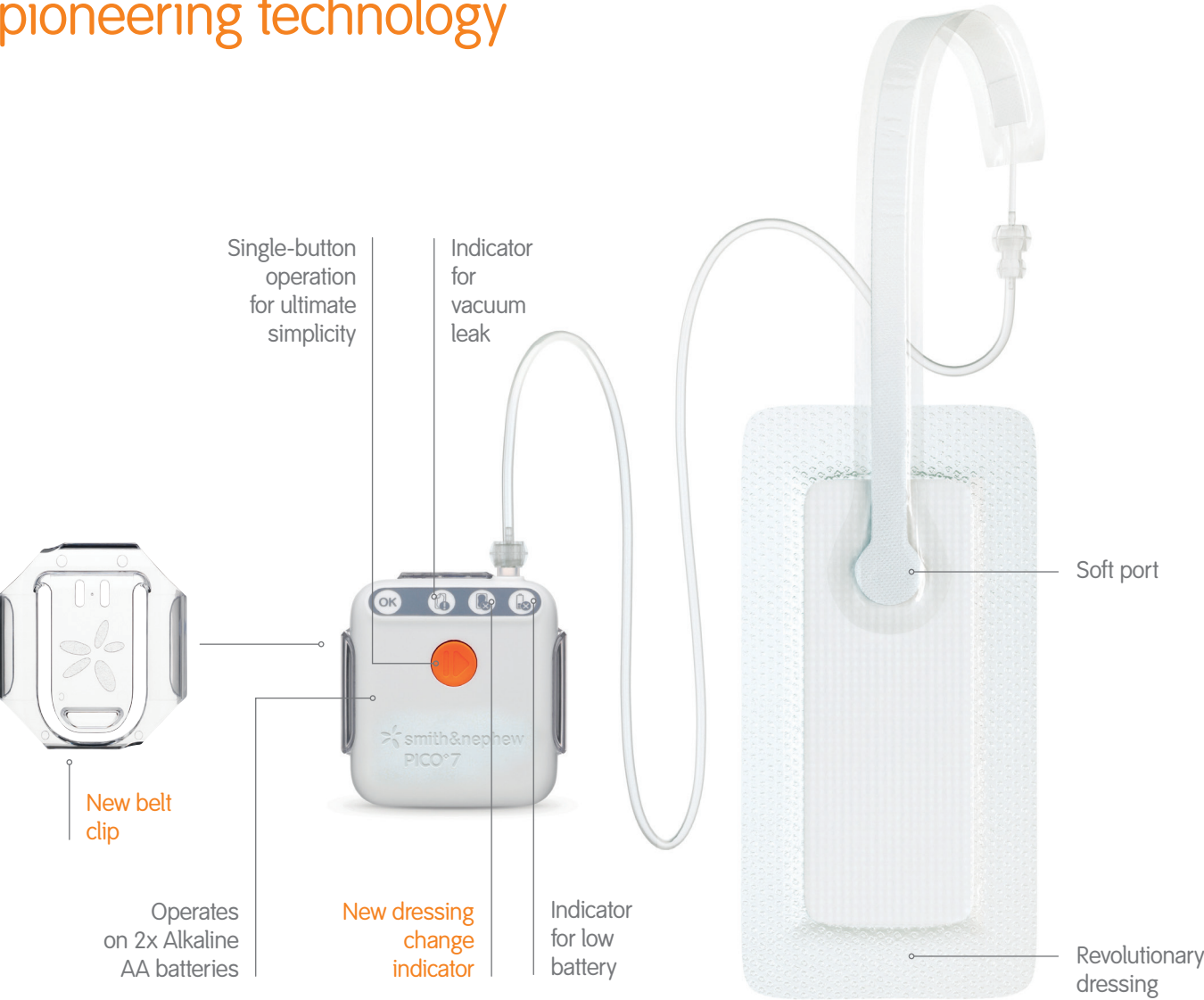

The best PICO we have ever made

Device performance

PICO pump is more than twice as effective at dealing with air leaks, than its predecessor.¹ This vastly improved efficiency could support healthcare professionals in delivering negative pressure and could potentially be used in problematic 'hard to seal' awkward areas

Ease of use

- New user interface with a dressing full indicator optimising dressing changes
- Area to write start date of therapy helping with healthcare protocols

Flexibility

Multipacks of 5 dressings now available, allowing therapy to be tailored to the patients clinicals needs

QoL for the patient

- Quiet just got even quieter²
- New belt clip for greater portability³

PICO° 7 for deep wounds

(2-7cm)⁴

PICO 7 dressing has been shown to be capable of managing low to moderate exudate, and deliver nominal -80mmHg therapeutic negative pressure in large wounds of depths upto 4.5cm when used with an appropriate NPWT filler*⁴

PICO can be used with or without fillers

A full assessment of the wound is recommended before considering whether it is appropriate to use a wound filler or to apply the PICO dressing directly to the wound.

If the wound depth is under 2cm the PICO dressing can be applied directly to the wound without the need for a filler. Depth – wounds greater than 0.5cm (¼in) in depth are likely to require a filler to ensure adequate treatment of all the wound surfaces.

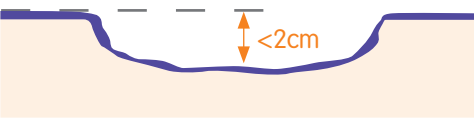

Wounds types under 2cm that the use of a filler would be appropriate:

- The wound bed is uneven
- There is undermining
- The wound is a sinus

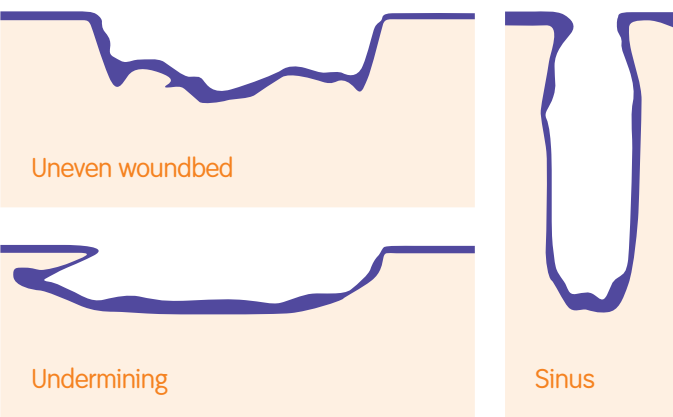

PICO fillers

If the wound depth is greater than 2cm deep you must use an appropriate NPWT filler. Both gauze and foam fillers are available for use with PICO to ensure that negative pressure reaches all surfaces of the wound cavity.⁴

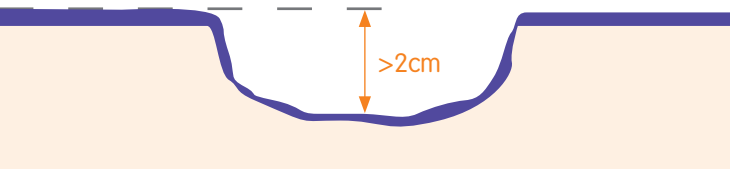

Application of the filler

Gauze filler

- Apply layer of saline-moistened antimicrobial gauze to wound bed. Continue to apply in layers until the gauze loosely fills the entire wound cavity.
- Avoid overpacking the wound cavity.
- Ensure the gauze is not overlapping onto the peri-wound area.

Foam filler

- Cut the foam to fit the size and shape of the wound.
- Do NOT cut the foam directly over the wound.
- Please ensure the foam is not overlapping onto the peri-wound area.

Status and troubleshooting

alerts and faults

Display status	Indicator status	Possible cause	Comments/troubleshooting
	All indicators off	The pump is in standby	NPWT is paused. Press the orange button to restart NPWT
		The pump has completed its course of Negative Pressure Wound Therapy (NPWT)	Pressing the orange button will not restart NPWT. Healthcare Professional to apply new pump and dressing if further NPWT is required
		The batteries have depleted	If the pump has not yet completed its course of NPWT, replace the batteries
	Green 'OK' indicator flashes	System is functioning properly. No issues	The pump may be heard running occasionally as it maintains the negative pressure. This is normal
	Green 'OK' and orange 'leak' indicators flash	The pump is working to achieve NPWT but has not reached the intended pressure.	Wait up to 65 seconds. Assess whether NPWT has been established.
	Green 'OK' and orange 'battery low' indicators flash	System is functioning properly but the batteries are low	Replace the batteries and press the orange button to restart therapy
	Orange 'leak' indicator flashes	A high air leak has been detected. NPWT is not being applied. (Note: the pump will automatically try to restart NPWT after 1 hour)	Smooth down the dressing and the strips to remove any creases. Press the orange button to restart NPWT. If the air leak remains, the orange leak indicator will start to flash after approximately 60 seconds. Ensure that the tube connectors have been twisted together securely
	Orange 'leak' and orange 'battery low' indicators flash	A high air leak has been detected and the batteries are low. NPWT is not being applied. (note: the pump will automatically try to restart NPWT after 1 hour)	Resolve the air leak according to instructions above. Also replace the batteries and press the orange button to restart therapy
	Orange 'dressing full' indicator flashes	Dressing is saturated or filter is blocked. NPWT is not being applied. (Note: the pump will automatically try to restart NPWT after 1 hour)	Healthcare professional to replace the dressing with a new one and press the orange button to restart NPWT
	Orange 'dressing full' and orange 'battery low' indicators flash	Dressing is saturated or filter is blocked and the batteries are low. NPWT is not being applied. (Note: the pump will automatically try to restart NPWT after (hour)	Healthcare professional to replace the dressing with a new one. Also replace the batteries and press the orange button to restart therapy
	All indicators solidly illuminated	A pump error has been detected. The pump can no longer apply NPWT	Healthcare professional to apply a new pump and dressing

* as demonstrated *in vitro*